



45 Gordon Dr Upper Coomera QLD

4  3  2 

Sensational large family sized home located within the scenic, quiet and peaceful Hinterland pocket of Upper Coomera bordering the Wongawallan foothills. Featuring an impressive 4 bedrooms with 2 x master bedrooms with Ensuites and beds 2 and 3 with 2 way main bathroom. The layout of this home accommodates the potential for dual living with lower level featuring a study, family/rumpus/lounge and bed with Ensuite separate from the upper living areas and beds/baths; ideal for larger or combined families for dual living to help ease rental costs. Enjoy outdoor living with with a pool and deck, wrap along sundeck and large outdoor Alfresco entertaining area overlooking parklands. Plus there is a purpose built bonfire pit area and large yard spaces on a fully fenced 1023m2 block - this home covers it all.

Type : House
Land Size : 1023 sqm
View : <https://www.coomerarealty.com.au/lease/qld/gold-coast/upper-coomera/residential/house/8587132>



Carmen Benson
0755734777

[For full version visit the website](https://www.coomerarealty.com.au)

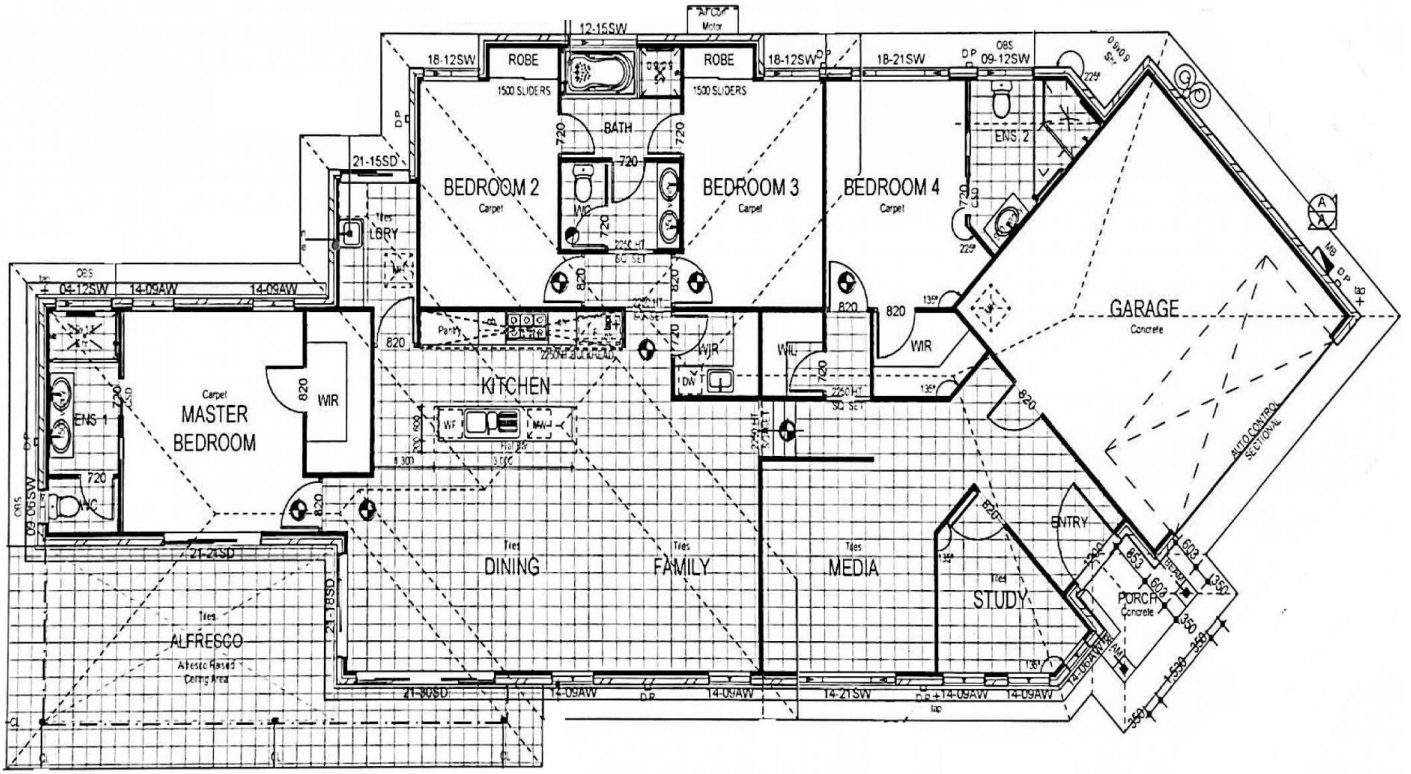

45 Gordon Drive, Upper Coomera

Total Area: 273.74m²



rentals@coomerarealty.com.au
5573 4777 | 0402 492 154

4 Bed 3 Bath (2 x Ensuite) 2 Car Pool | 1,023m²

DISCLAIMER: This is not a legal document therefore all measurements and information provided is subject to survey.