

1/6 Mocha Way Pimpama QLD

3  **2**  **2** 

Perfectly positioned in one of Pimpama's most central pockets, 'Hawthorne Woods' estate; this modern three-bedroom duplex home offers the ideal blend of comfort, practicality and investment appeal. Whether you're starting out, slowing down or adding to your investment portfolio, this one ticks all the boxes and more.

Step inside and enjoy the functional and well-designed floor-plan offering light-filled open plan centralised living and dining, designed for easy everyday living and entertaining. The kitchen sits at the heart of the home, whilst sliding doors flow outside to a private underroof double length entertaining area and private backyard offering the ideal blend of low-maintenance living and perfect for the kiddies and pets.

[For full version visit the website](https://www.coomerarealty.com.au/sale/qld/gold-coast/pimpama/residential/semi-detached/8457871)

Type : Semi Detached
Price : \$ 810,000
Land Size : 162 sqm
View : <https://www.coomerarealty.com.au/sale/qld/gold-coast/pimpama/residential/semi-detached/8457871>



Sophie Watts
0417 435 056



Tyler Benson
0413 815 816

NORTH ↑

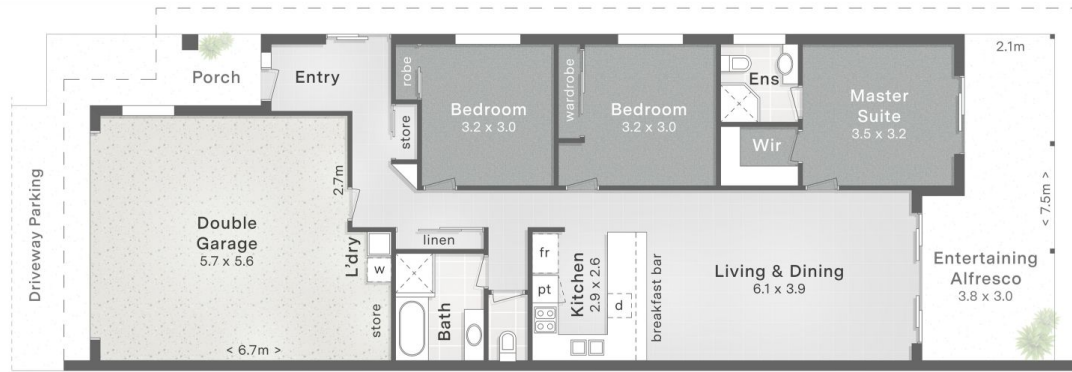

FLOOR PLAN



SITE PLAN

1. Driveway Parking
2. Entry Porch
3. Side Access Gate
4. Clothes Line
5. Entertaining Alfresco
6. Fenced Grass Yard



1/6 Mocha Way Pimpama

Internal 142m² | Alfresco & Porch 24m²

→ 3 Bed → 2 Bath → 2 Car + Off-Street

Total 166m²

Tyler Benson 0413 815 816
 Sophie Watts 0417 435 056

DISCLAIMER: This is not a legal document therefore all measurements and information provided is subject to survey. No permission is given to use or alter this Floor Plan without the consent of FloorScope. The overall presentation style, layout, imagery, fonts, background, colours and terminology has been originally created by FloorScope & is subject to strict copyright. No ownership is taken of building design. Find out more at floorscape.au

